

# ALUCOBOND® easy fiX

PROCESSING BROCHURE | easy fiX 90°/135°



# TABLE OF CONTENTS

---

01. <b>General Information</b>	3
02. <b>Combinations</b>	7
03. <b>Fabrication</b>	10
04. <b>easy fiX 90°/135°</b>	14

# GENERAL INFORMATION

## The concept of ALUCOBOND® easy fiX is simple

Hybride solution between face fixed panels and cassette solutions

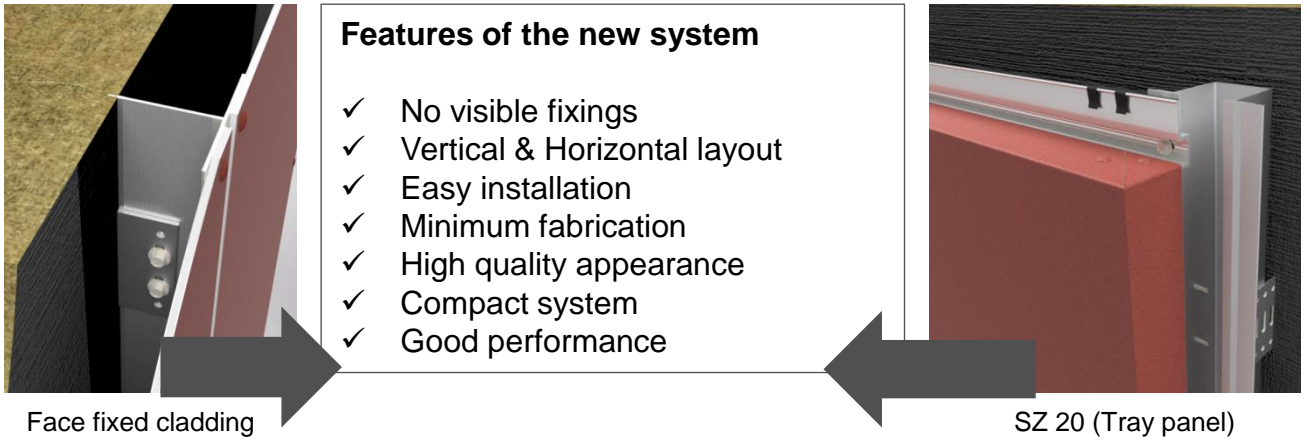

**Features of the new system**

- ✓ No visible fixings
- ✓ Vertical & Horizontal layout
- ✓ Easy installation
- ✓ Minimum fabrication
- ✓ High quality appearance
- ✓ Compact system
- ✓ Good performance

Face fixed cladding

SZ 20 (Tray panel)

A new solution combining technology, ease of installation and architectural performance for new or renovated buildings.



# GENERAL INFORMATION

---

## Concept

The concept of ALUCOBOND® easy fiX is a simple clamping solution with invisible fixing, in combining 2 types of folds

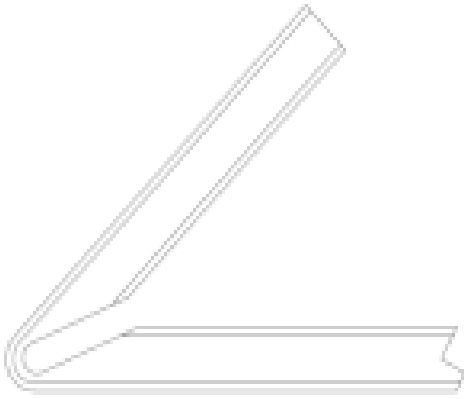

Simple fold 135°



Double fold 90°/90°

## Possibilities of combination

Combination of 2 types of milling gives 3 different types of panels:

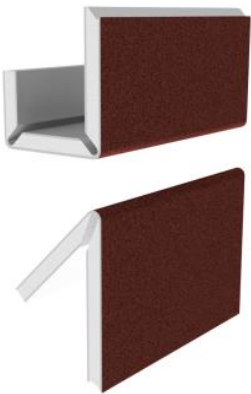

easy fiX 90°+135°

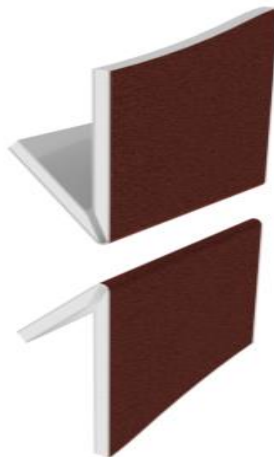

easy fiX 135°+135°

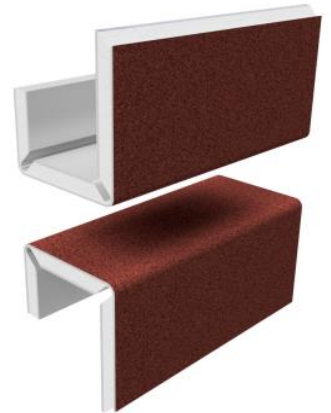

easy fiX 90°+90°

# GENERAL INFORMATION

## Horizontal and vertical installation

ALUCOBOND® easy fiX panels can be installed with horizontal or vertical layout, and can also be mixed horizontal and vertical together.

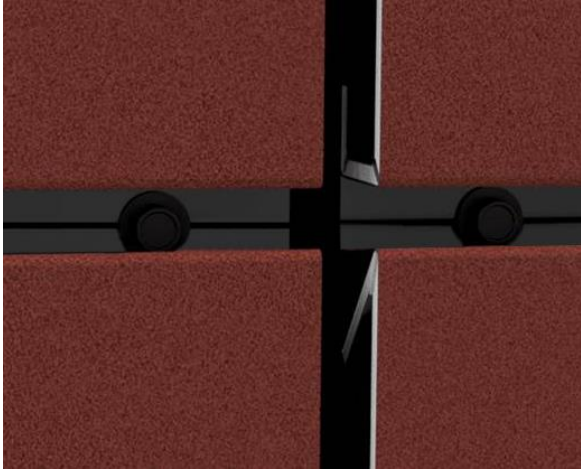

Horizontal layout

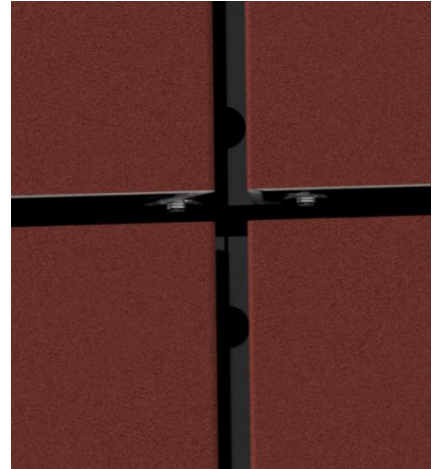

Vertical layout

## Types of installation

There are 3 possible types of installation:

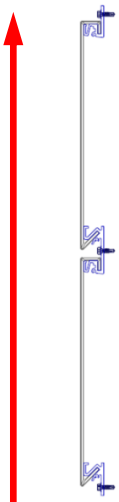

From bottom to top

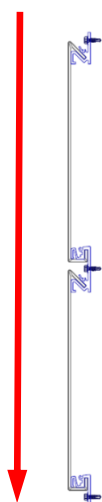

From top to bottom

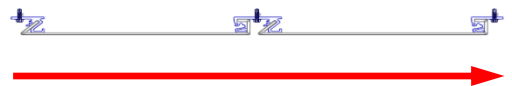

From left to right (and reverse)



# GENERAL INFORMATION

---

## Profiles

- easy fiX panels can be clamped with short profiles or with continuous one.
- Possible to buy short profiles (60mm) or long profile (4 or 6 meters), blank or black anodised.

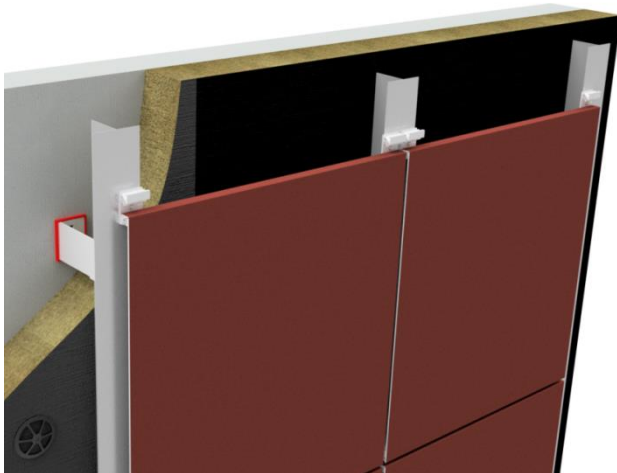

Point fixings

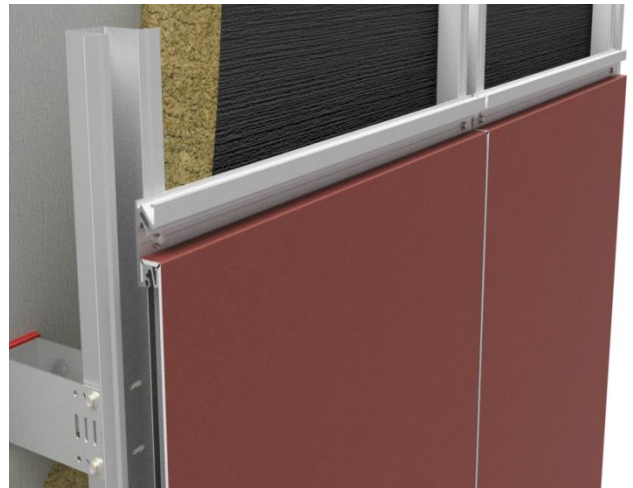

Linear fixing

## Various Layouts

Optionally, the layout of the easy fiX cassettes can be horizontal and / or vertical. Thus leaving architectural freedom.

## Excellent edge finish

The folding is made from a V-groove, the bending of the returns is easy with the finest rendering.

## Invisible fixings

The clamping solution, both simple and economical, without adding rivets, gives an excellent visual rendering.

## Compact system

Without rivets, the cassette thickness is reduced to 31mm, limiting the size of the cladding.

# COMBINATIONS

## Fixings

Combination of 2 types of milling gives 3 different types of tray panels:

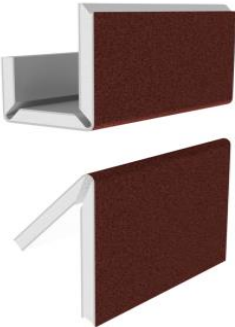
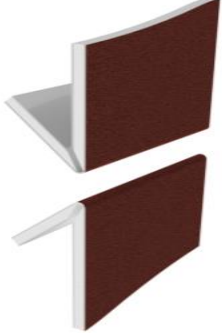
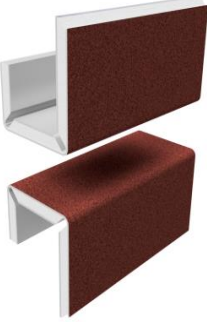
		
<ul style="list-style-type: none"> <li>• 3 milling lines/panel</li> <li>• Better leveling</li> <li>• Folding of easy fiX elements has a positive effect on environmental soiling on the front side</li> <li>• Up to 10mm joint</li> <li>• Linear and punctual fixings</li> <li>• Not possible with Reflect 405</li> </ul>	<ul style="list-style-type: none"> <li>• 2 milling lines/panel</li> <li>• Easy folding process</li> <li>• Folding of easy fiX elements has a positive effect on environmental soiling on the front side</li> <li>• Up to 12mm joint</li> <li>• Linear and punctual fixings</li> <li>• Not possible with Reflect 405</li> </ul>	<ul style="list-style-type: none"> <li>• 4 milling lines/panel</li> <li>• Better leveling</li> <li>• Cassette appearance</li> <li>• Folding of easy fiX elements has a positive effect on environmental soiling on the front side</li> <li>• Up to 15mm joint</li> <li>• Only punctual fixings</li> <li>• Possible with Reflect 405</li> </ul>



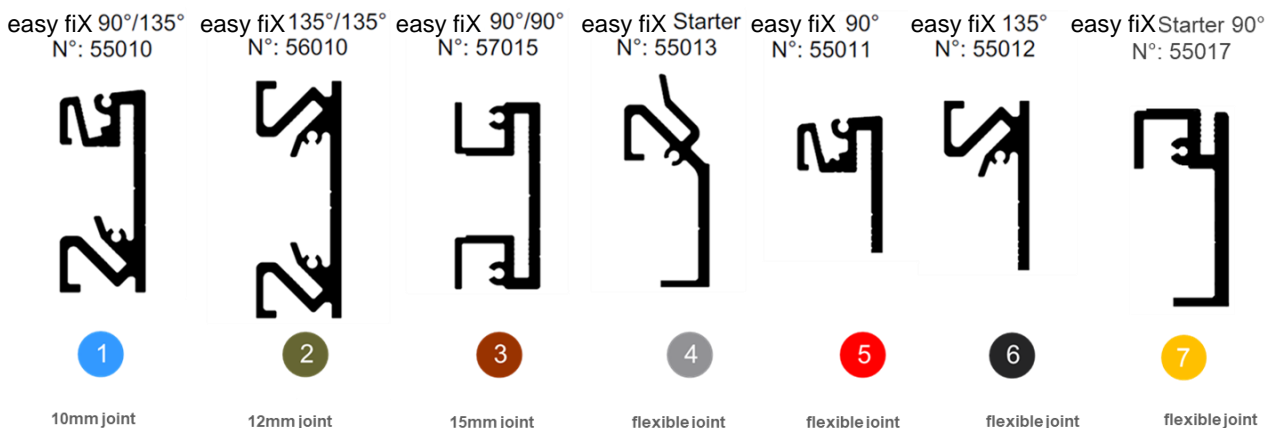

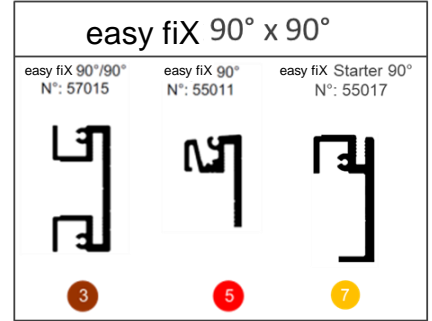
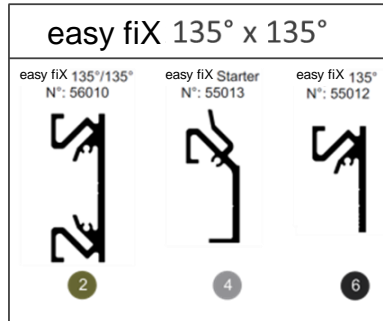
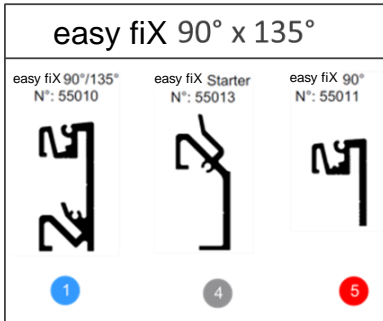

## 7 Profiles resulting of the different combinations of folds

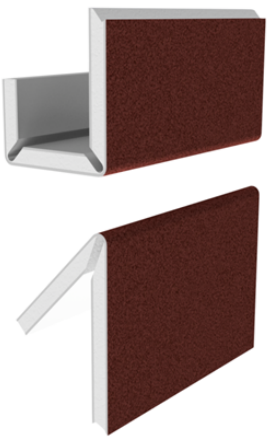

# COMBINATIONS

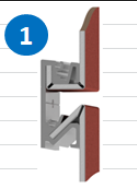
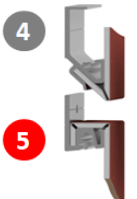

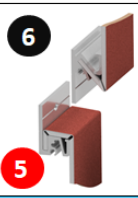



## Appearance 135°/90°

Appearance 135°/90°	Installation		Support minimum width	Joint	Fixing	
	bottom to top	top to bottom			Point	Continuous
			40mm	10mm	✓	✓
			40mm	flexible	✓	✓
			100mm	flexible	✓	✗







# COMBINATIONS

## Appearance 135°/135°

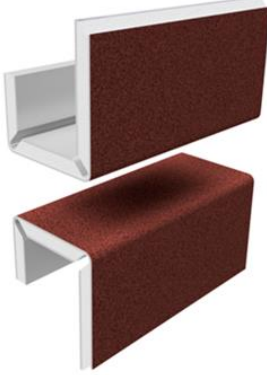
Appearance 135°/135°	Installation		Support minimum width	Joint	Fixing	
	bottom to top	top to bottom			Point	Continuous
	2		40mm	12mm	✓	✓
	6		40mm	flexible	✓	✓
	4		6	100mm	flexible	✓

## Appearance 90°/90°

Appearance 90°/90°	Installation		Support minimum width	Joint	Fixing	
	bottom to top	top to bottom			Point	Continuous
	3		40mm	≥15mm	✓	✗
	5		100mm	flexible	✓	✗
	7		5	40 mm	flexible	✓

# FABRICATION

## Appearance 90°/135°

Appearance 90°/135°	Installation		Support minimum width	Joint	Fixing	
	bottom to top	top to bottom			Point	Continuous
<b>Variants</b>			40mm	flexible	✓	✓
			40mm	flexible	✓	✓

## Geometry of milling tools

easy fiX tray panels are simply made with 2 types of milling lines:

### Geometry for vertical saw blade

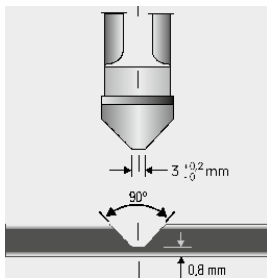

V-groove 90°

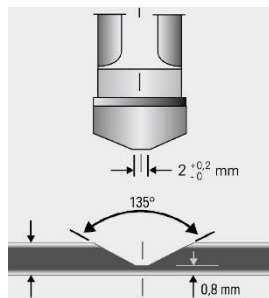

V-groove 135°

### Geometry for CNC machine

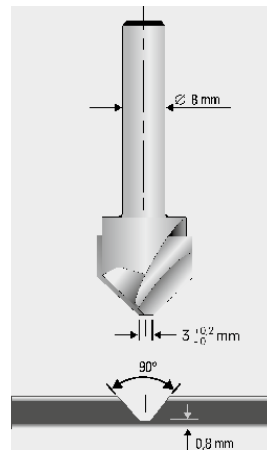

V-groove 90°

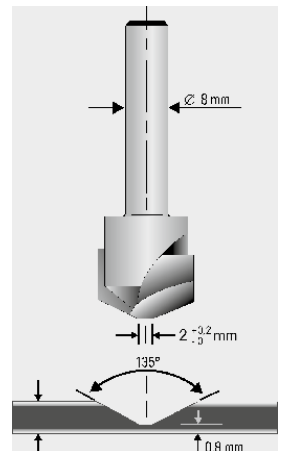

V-groove 135°

# FABRICATION

## Folding table

The folding table must have the same length than the panel.



The table is too short!



The edge is not straight!



The table is bigger than the panel



The edge is straight

# FABRICATION

## Folding technique

The protective foil should be well cut for a better folding.

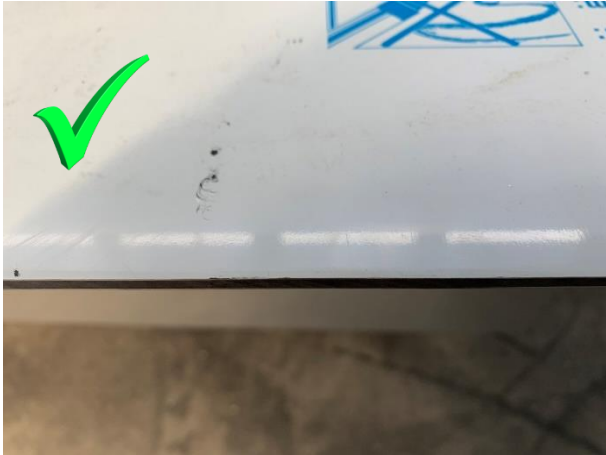

Easyfix 90°  
N°: 55011

## Folding technique

- The easy fiX 90° profile can be used as a bending aid.
- Punch the edge of ALUCOBOND® panel (120mm width)
- Then insert the panel into the profile and use it as a bending tool



# FABRICATION

## Position of the routing lines

- Combination of 2 types of milling gives 3 different types of tray panels.

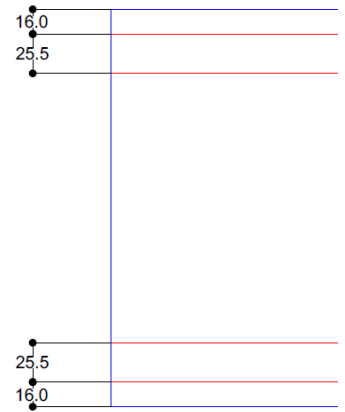
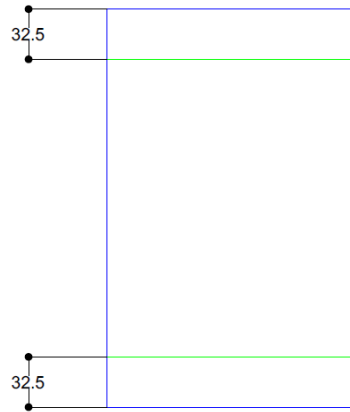
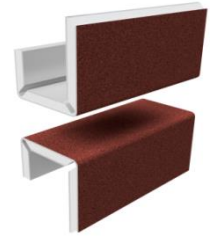
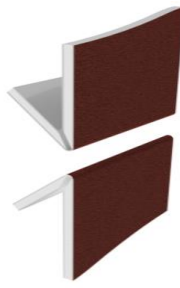
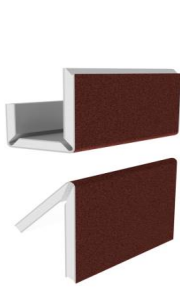

# easy fiX 135°/90°

## Position of the routing lines

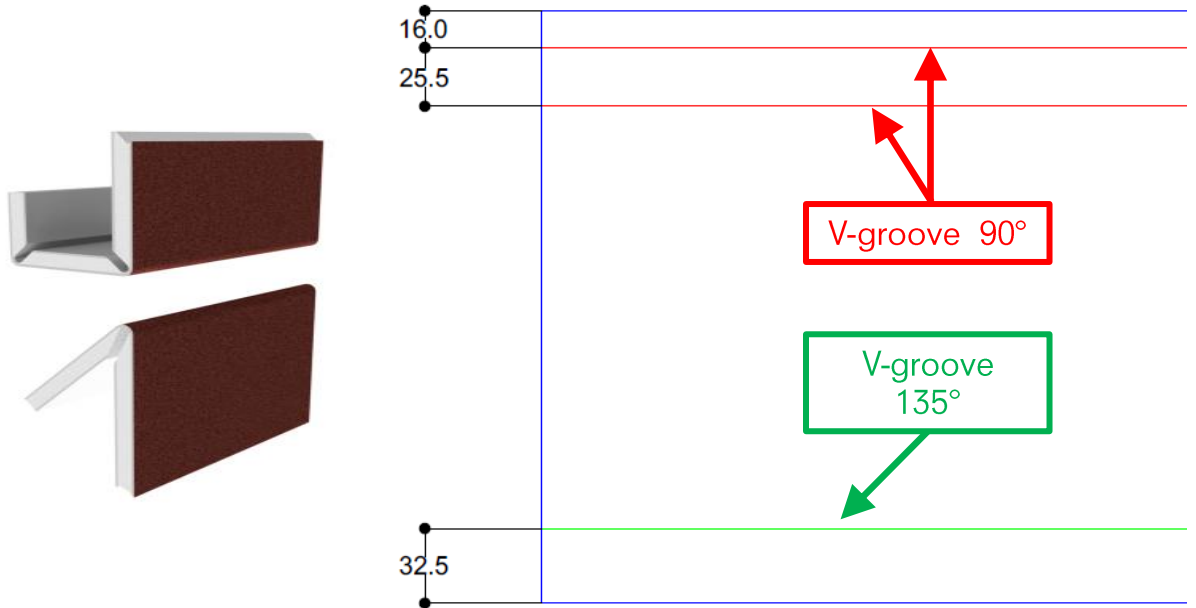

## Folding technique

- 2 types of fold = 2 folding techniques

Double folding 90°

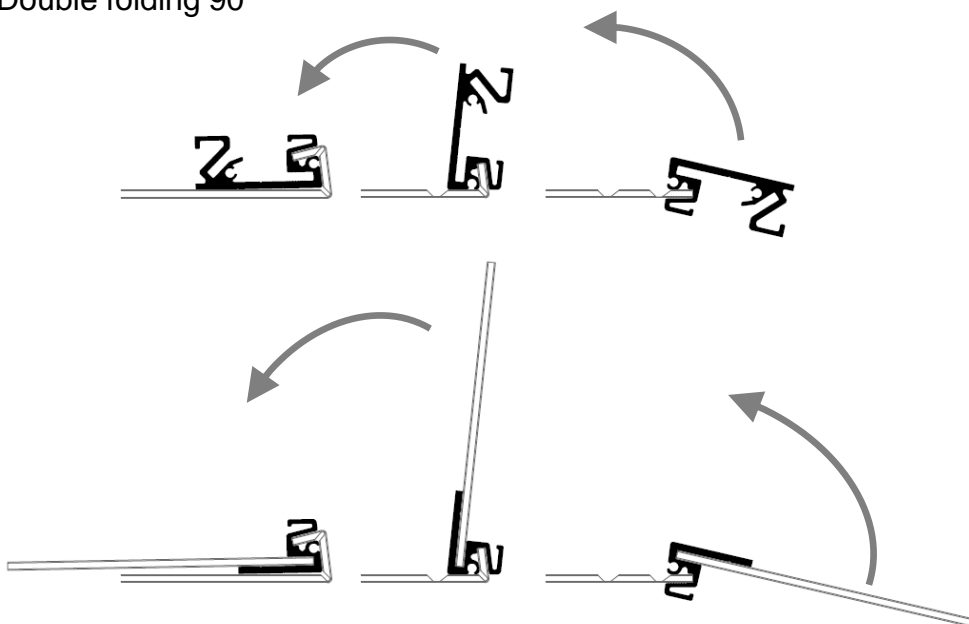



# easy fiX 135°/90°

## Folding table

- Position of the profile to make the double folding 90°
- Respect the steps: rotate the 1st fold, then the 2nd fold
- Then cut the protective foil with the 3AC remover

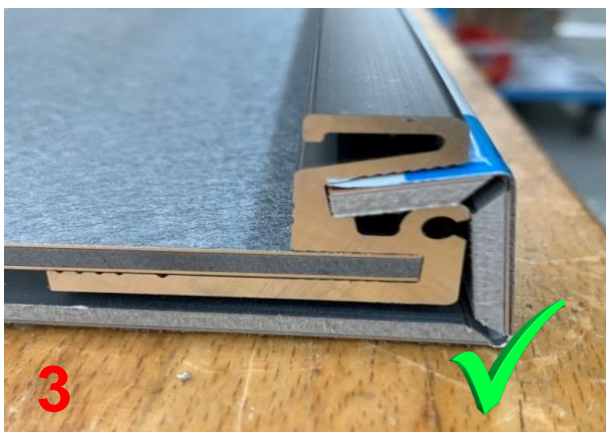
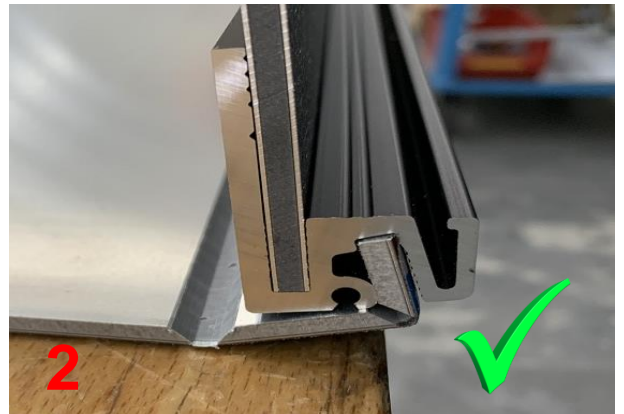

## easy fiX 135°/90°

### Folding table

- Respect the steps or it will be impossible to install the panel!

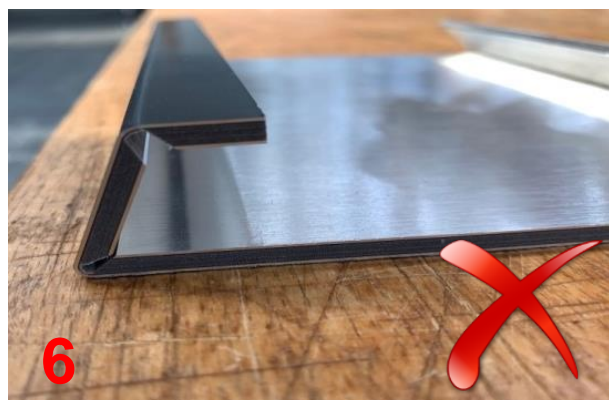
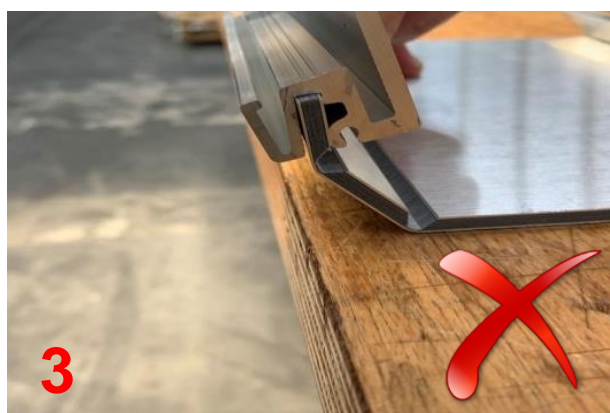

# easy fiX 135°/90°

## Folding technique

- 2 types of fold = 2 folding techniques
- Simple folding 135°

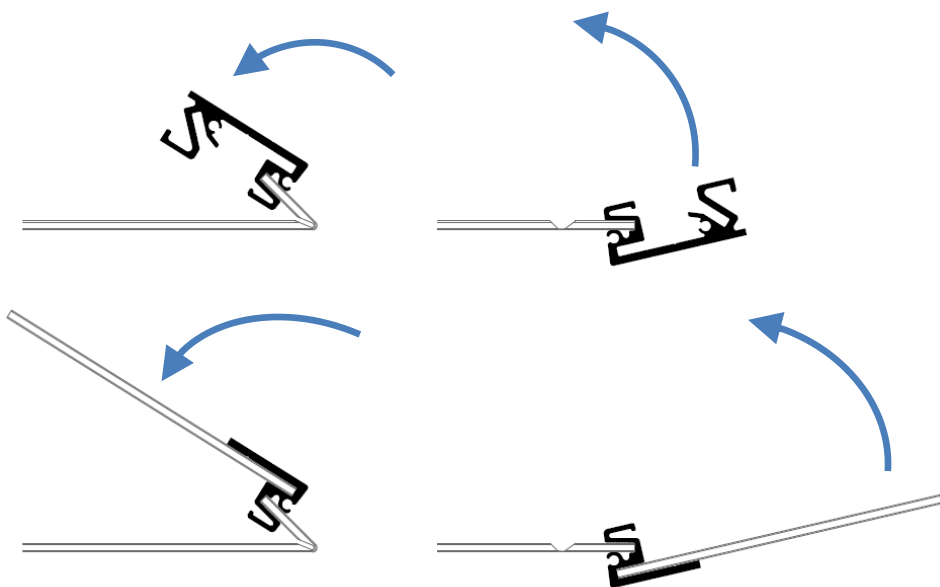

- Position of the profile to make simple folding 135°
- Then cut the protective foil with the 3AC remover

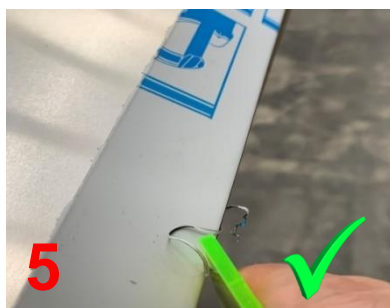
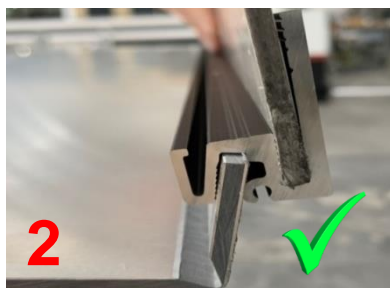
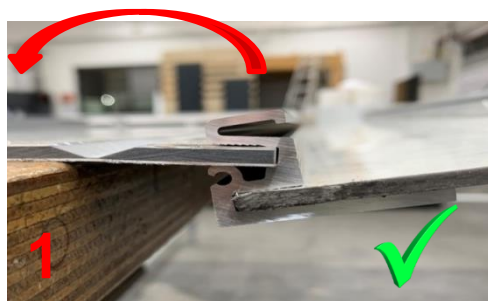



## easy fiX 135°/90°

### Cut-to-size

1<sup>st</sup> step : Draw the cut lines on the rear side of the panel.



2<sup>nd</sup> step : Cut-to-size following the cut lines.

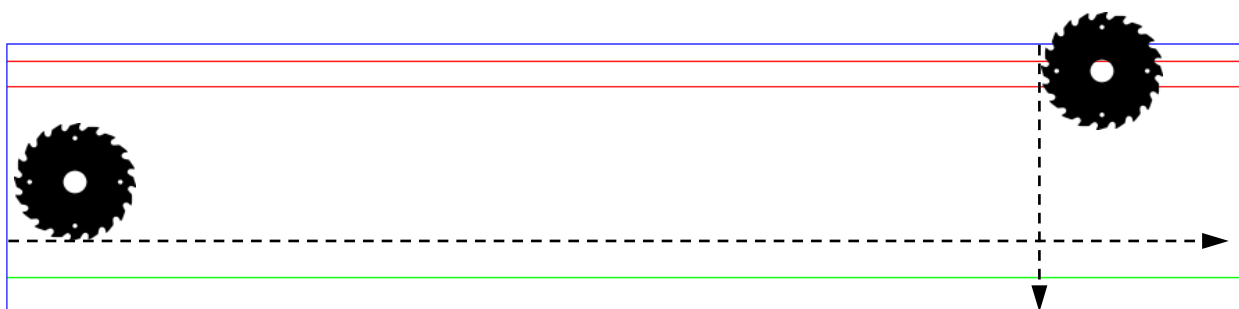

- Cut the panel with hand saw cutting machine Festool PF 1200 E-plus Alucobond.



## easy fiX 135°/90°

### Cut-to-size

3<sup>rd</sup> step : creating a new V-groove 135°



- Position the hand milling machine Festool PF 1200 E-plus Alucobond or TSC 55 REB Alucobond and mill following the line.

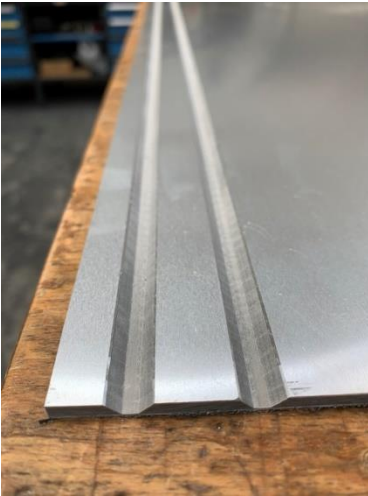

- The panel is now at the correct size to finalize facade.

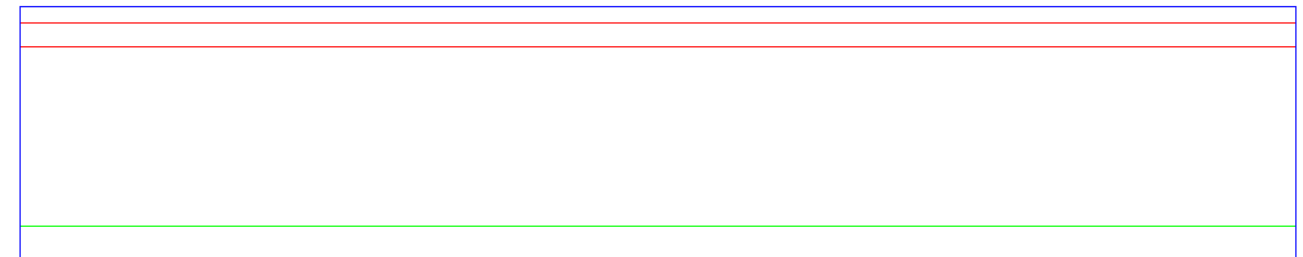

## easy fiX 135°/90°

---

### Cut-to-size

- The edges can be deburred to avoid cuts during the handling



- The last panels can be delivered on the building site, bigger than necessary and with only one side milled.

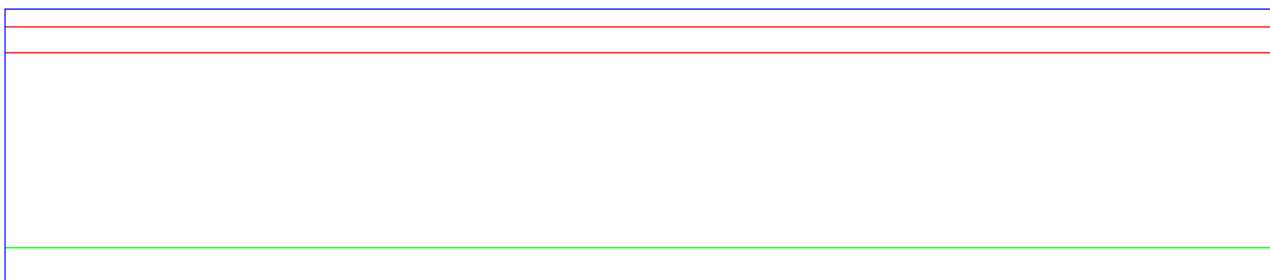



## easy fiX 135°/90°

### Cut-to-size

- In case trapeze shape, you can cut little piece of folds with the trimmer “original Lowe” ([www.original-lowe.de](http://www.original-lowe.de)) in case of parallelogram or trapeze shapes.

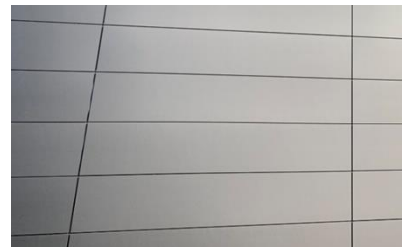

### Hole diameter on profiles

- The short profiles must be 60mm length and have 1 countersunk hole Ø6mm. The long profile must have 1 hole Ø6mm to create a fix point, and the others must be slot holes 6x20mm, for thermal expansion issues.



## Fixings

In the countries where national approval is mandatory, screws must have approval for examples:

Screws for aluminium substructure:

- Ejoyt:
  - JT4-6-5,5x22
  - JT9-VARIO
  - JT4-FR-4-4,8x19
- SFS:
  - SDA5
  - SFS 12–16 ACM Countersunk screw (Ref. 1550984)
- Hilti:
  - S-AD x1 LPS5 5,5 xL
  - S -AD x1 LSS 5,5xL
  - S-MD x1 LSS 5,5 xL

## Installation – horizontal layout – from top to bottom

- easy fiX panels can be installed horizontally from top to bottom
- The installation is the same than from bottom to top

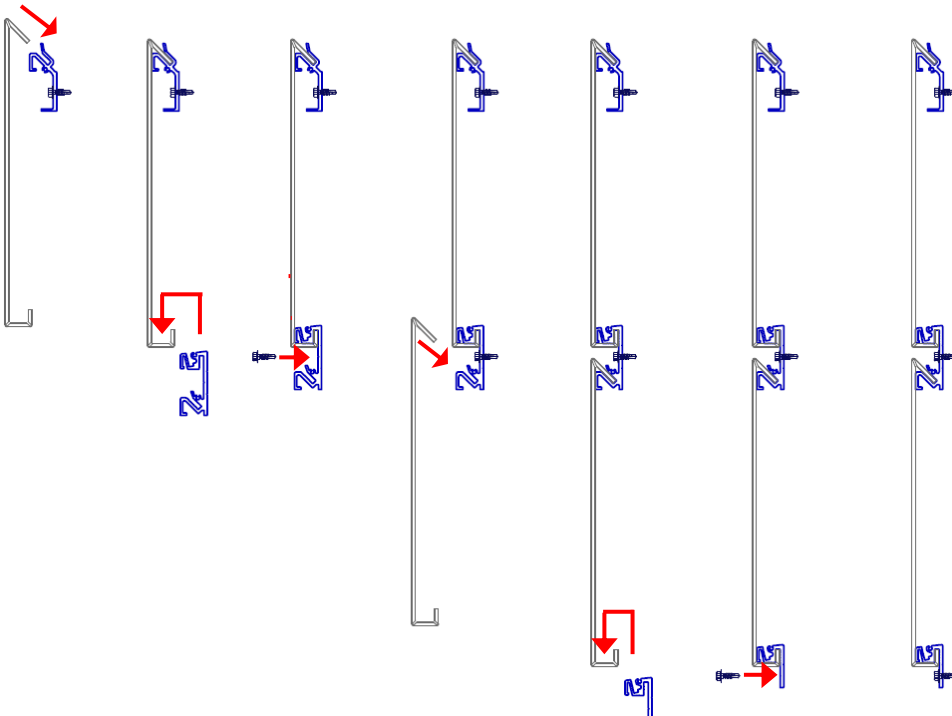

## easy fiX 135°/90°

### Installation – horizontal layout – from bottom to top

- easy fiX panels can be installed horizontally from bottom to top
- The installation is the same than from top to bottom (reversed panel/profile)

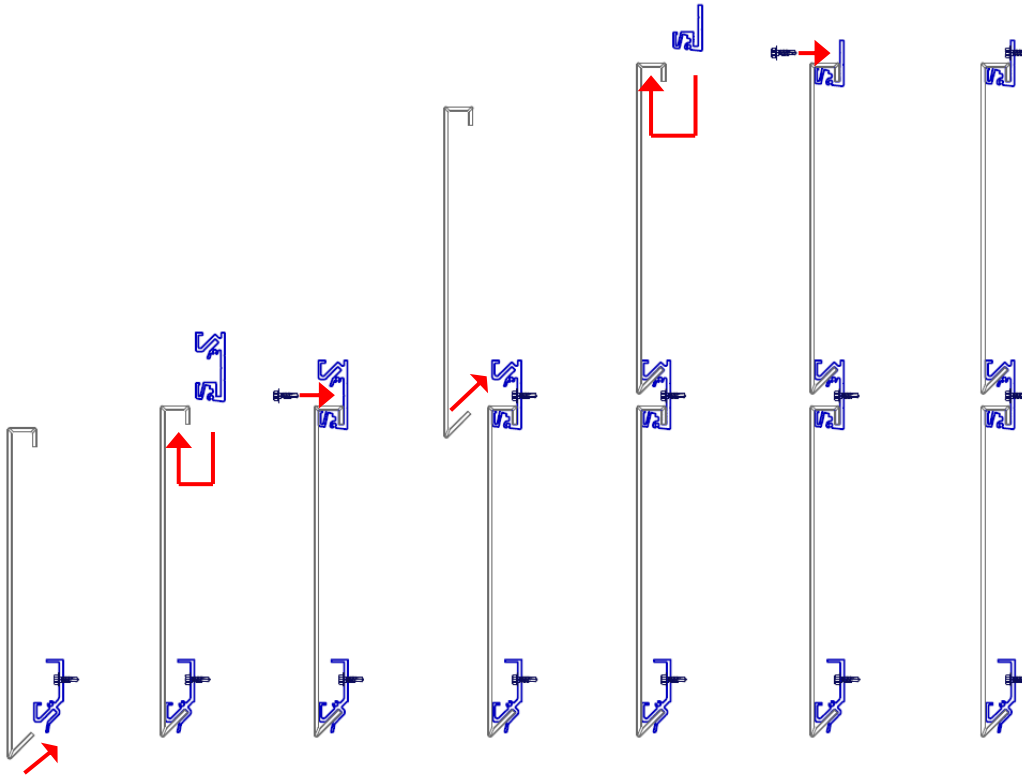

- Level the starting profiles, then insert the panel into the profiles

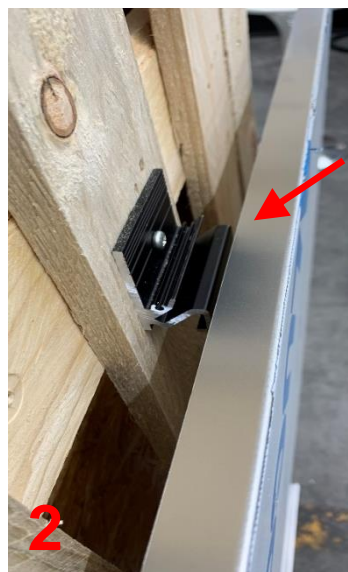

## easy fiX 135°/90°

### Installation – horizontal layout – from top to bottom

- Insert the profiles into the bottom fold and slide it in front of the support



- Insert the panel into the profiles

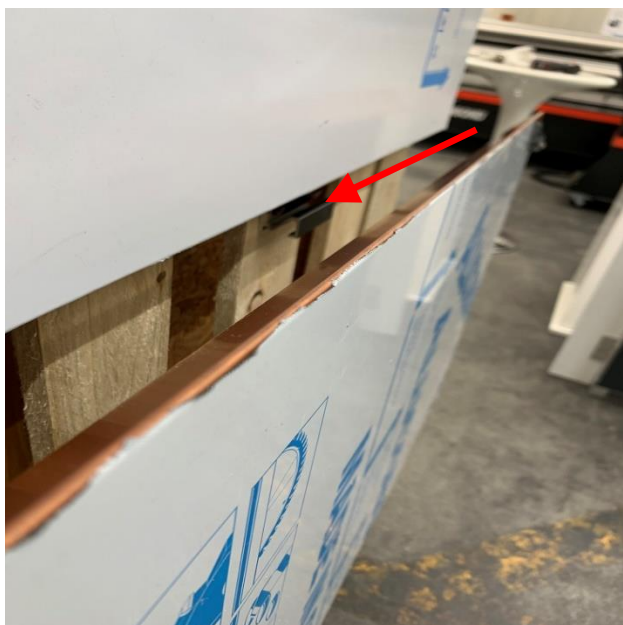



## easy fiX 135°/90°

### Installation – horizontal layout – from top to bottom

- Insert the end profile into the bottom fold and slide it in front of the support

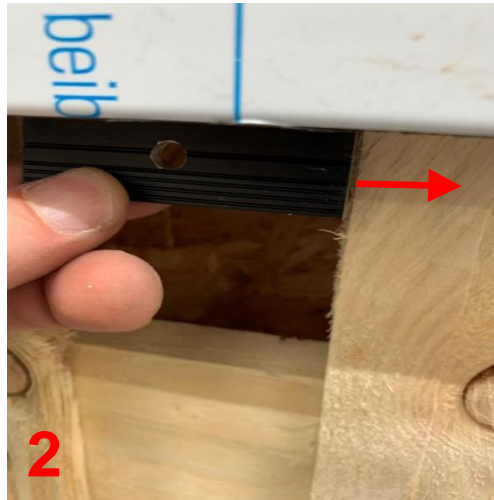

### Fixed points – solution 1 – for linear fixing

- Position 1 screw on the rear side of the continuous profile
- This screw will block panel and create a fixed point



## easy fiX 135°/90°

### Fixed points – solution 2 – for point fixing

- Position 2 screws each side of one profile per panel
- The 2 screws are fixed on the 2nd fold (the shortest one)
- These 2 screws will block panel and create a fixed point



### Fixed points – solution 3 – for point fixing

- Position 2 screws each side of one profile per panel
- The 2 screws are fixed on the 1st fold
- These 2 screws will block panel and create a fixed point

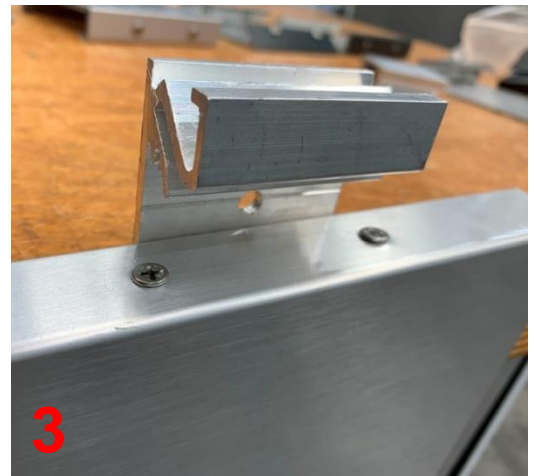



# Easy fix 90°/135° – Removal

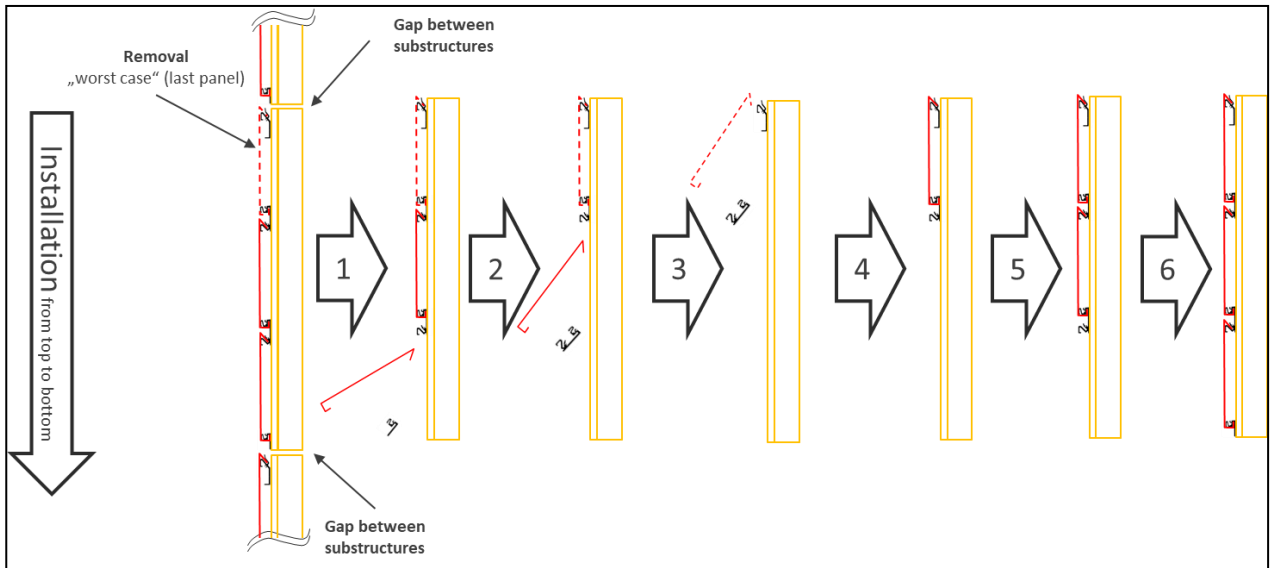
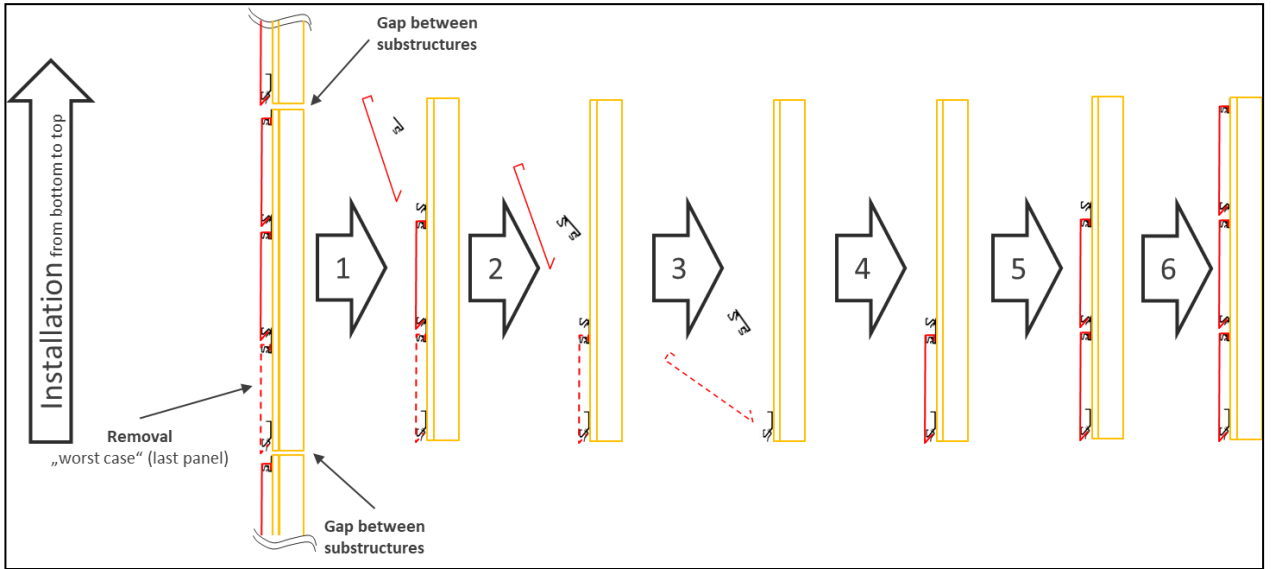

## Technical details – horizontal layout

- Horizontal joint

**ALUCOBOND®**

Fascia, easy fiX Panels - Horizontal Layout  
- Short fixing profiles

Horizontal joint (Section 1-1) M 1:2

Horizontal joint see page 3.20A

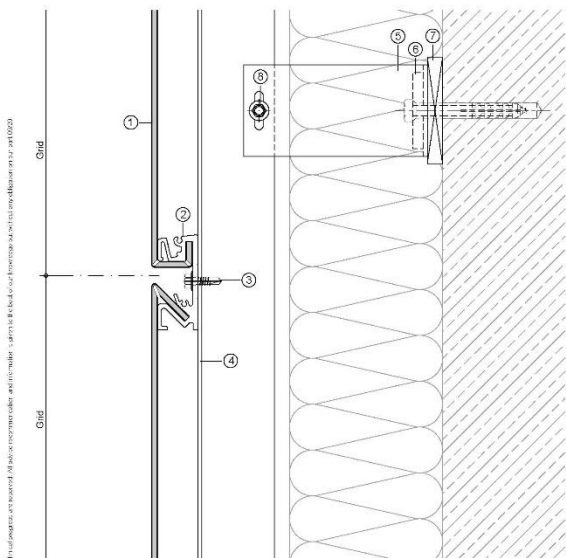
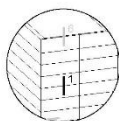

- ① ALUCOBOND  
 ② easy fiX Standard Profil 55010 (Short piece L=60 mm)  
 ③ Self-tapping screw or self-drilling screw  
 ④ T-/L-section

- ⑤ Wall bracket (L/J U)  
 ⑥ Extruded Al-liner  
 ⑦ Plastic board (thermal separation)  
 ⑧ self-drilling screw

Part 5 3.10

**ALUCOBOND®**

Fascia, easy fiX Panels - Horizontal Layout  
- Short fixing profiles

Vertical joint (Section 2-2) M 1:2

Vertical section see page 3.10

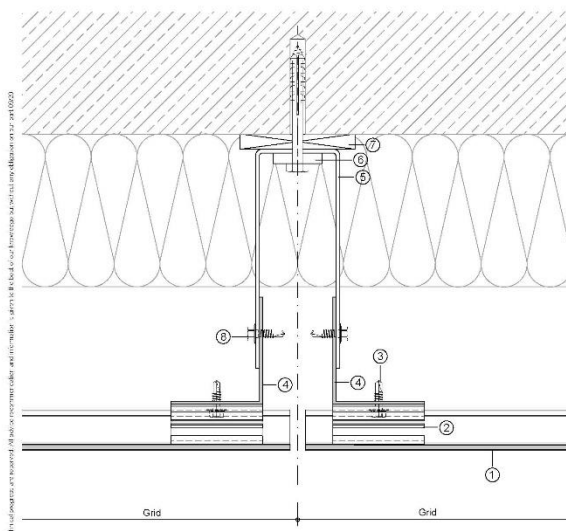
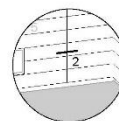

- ① ALUCOBOND  
 ② easy fiX Standard Profil Nr 55010 (Short piece L=60 mm)  
 ③ Self-tapping screw  
 ④ T-/L-section

- ⑤ Wall bracket (L/J U)  
 ⑥ Extruded Al-liner  
 ⑦ Plastic board (thermal separation)

Part 5 3.20A

# easy fiX 135°/90°

## Technical details – horizontal layout

- Horizontal joint

**ALUCOBOND®**

Fascia, easy fiX Panels - Horizontal Layout  
- Short fixing profiles

Horizontal joint (Section 1'-1') M 1:2

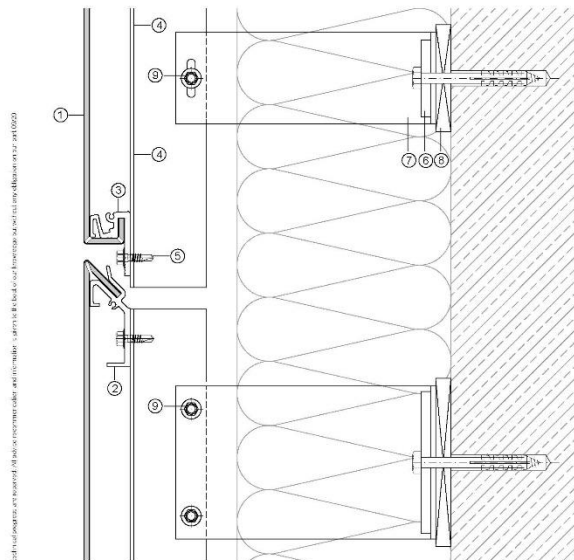
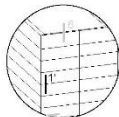

- |   |                                      |
|---|--------------------------------------|
| ① ALUCOBOND   | ⑥ Extruded Al-liner                  |
| ② easy fiX 135° Profile 55013 (short piece L=60 mm) | ⑦ Wall bracket (L / U)               |
| ③ easy fiX 90° Profile 55011 (short piece L=60 mm)  | ⑧ Plastic board (thermal separation) |
| ④ T- / L-Section                                    | ⑨ Self-drilling screw                |
| ⑤ Self-tapping screw or self-drilling screw         |                                      |

Part 5 3.10B

**ALUCOBOND®**

Fascia, easy fiX Panels - Horizontal Layout  
- Short fixing profiles

Horizontal joint (Section 1-1') M 1:2

Horizontal joint see page 3.20A

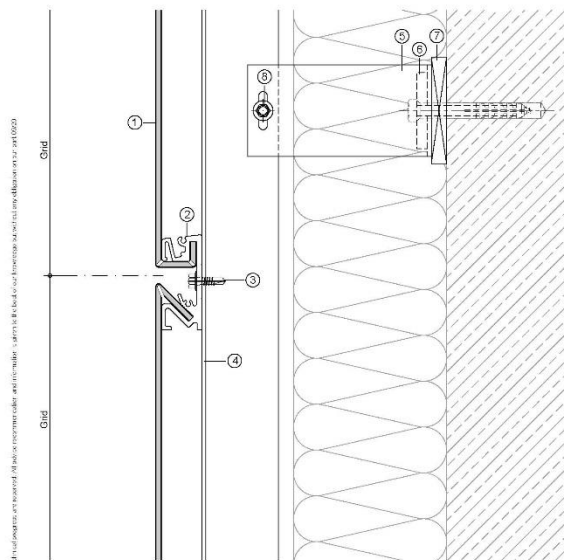
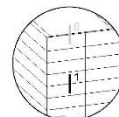

- |   |                                      |
|---|--------------------------------------|
| ① ALUCOBOND   | ⑥ Wall bracket (L / U)               |
| ② easy fiX Standard Profile 55C10 (Short piece L=60 mm) | ⑦ Extruded Al-liner                  |
| ③ Self-tapping screw or self-drilling screw             | ⑧ Plastic board (thermal separation) |
| ④ T- / L-section  | ⑨ self-drilling screw                |

Part 5 3.10

# easy fiX 135°/90°

## Technical details – horizontal layout

- Horizontal joint

**ALUCOBOND**

Fascia, easy fiX Panels - Horizontal Layout  
- Short fixing profiles

Horizontal joint (Section 1'-1') M 1:2

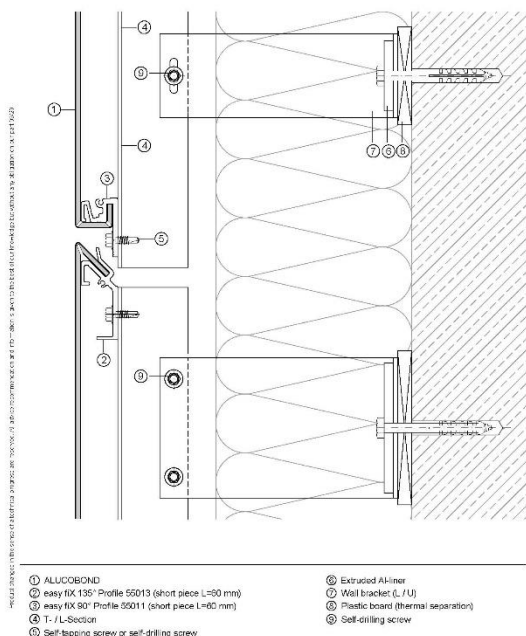

- |   |                                      |
|---|--------------------------------------|
| ① ALUCOBOND   | ⑥ Extruded Al-liner                  |
| ② easy fiX 135° Profile 55013 (short piece L=50 mm) | ⑦ Well bracket (L / U)               |
| ③ easy fiX 90° Profile 55011 (short piece L=60 mm)  | ⑧ Plastic board (thermal separation) |
| ④ T- / L-Section                                    | ⑤ Self-tapping screw                 |
| ⑧ Self-tapping screw or self-drilling screw         |                                      |

Part 6 3.10B

## Installation – vertical layout

- easy fiX panels can be installed vertically (no fixed point required)

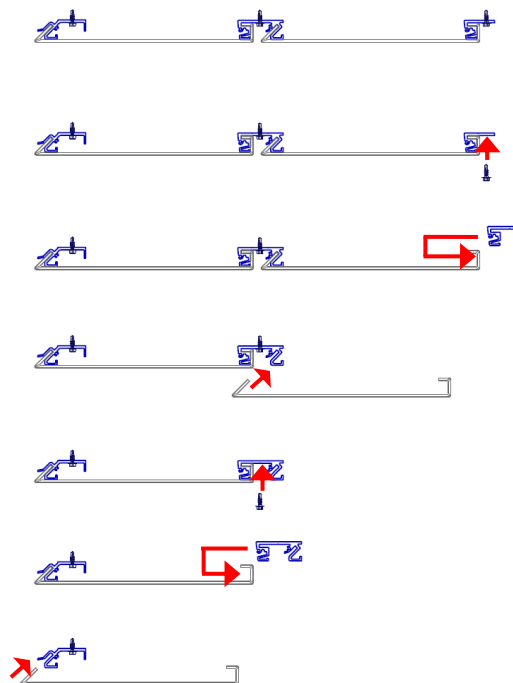

# easy fiX 135°/90°

## Installation – vertical layout

- There are channels on each easy fiX profiles, they can be used to fix washers and screws, in order to support the panels.

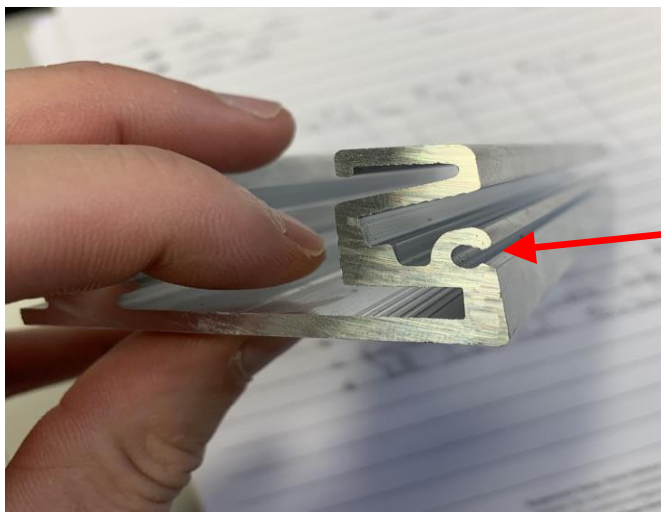

- Support for vertical panels

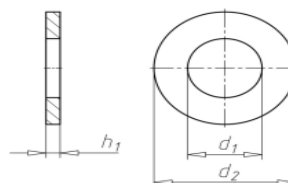
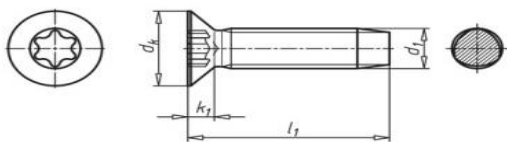

GEFU® thread-forming screw with Taptite  
2000® thread  
Stainless steel A2 bright TX countersunk head  
SHR-SEKPF-TT2000-TX20-A2-M4.0X16  
TAPTITE2000

Washer stainless steel  
 $h=1,2\text{mm}$   $d_1=5,3\text{mm}$   $d_2=15\text{mm}$



# easy fiX 135°/90°

## Installation – vertical layout

- Level the starting profiles, then insert the panel into the profiles

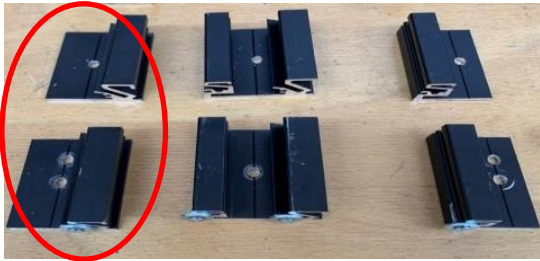

2 screws for the starter profile at bottom

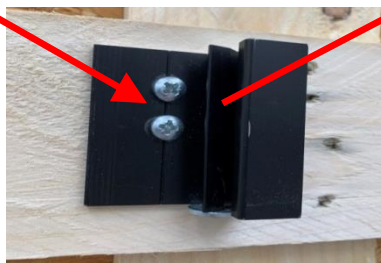
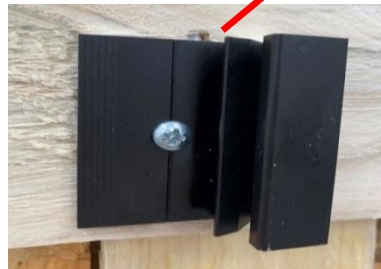

- Insert the panel into the starting profiles

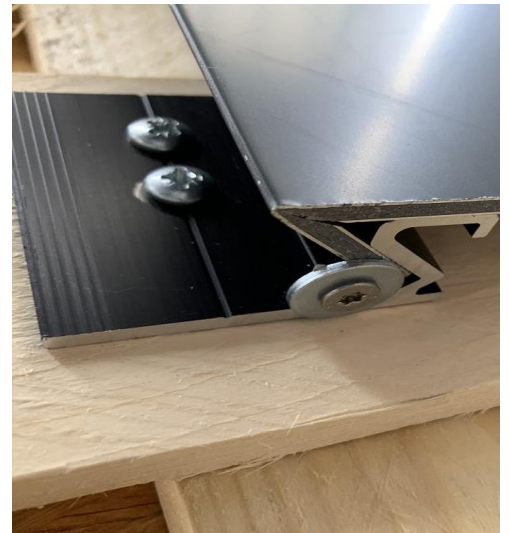



# easy fiX 135°/90°

## Installation – vertical layout

- Insert the profiles into the fold on the right

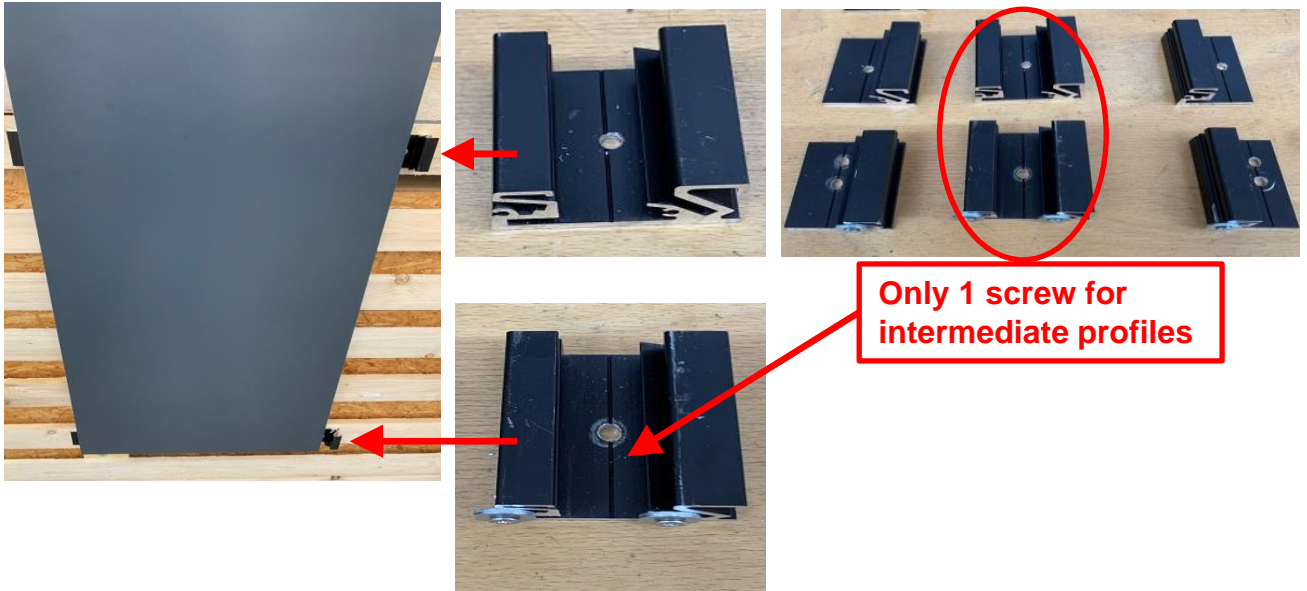

- Slide the profile in front of the support, only 1 screw is required for the bottom intermediate profiles

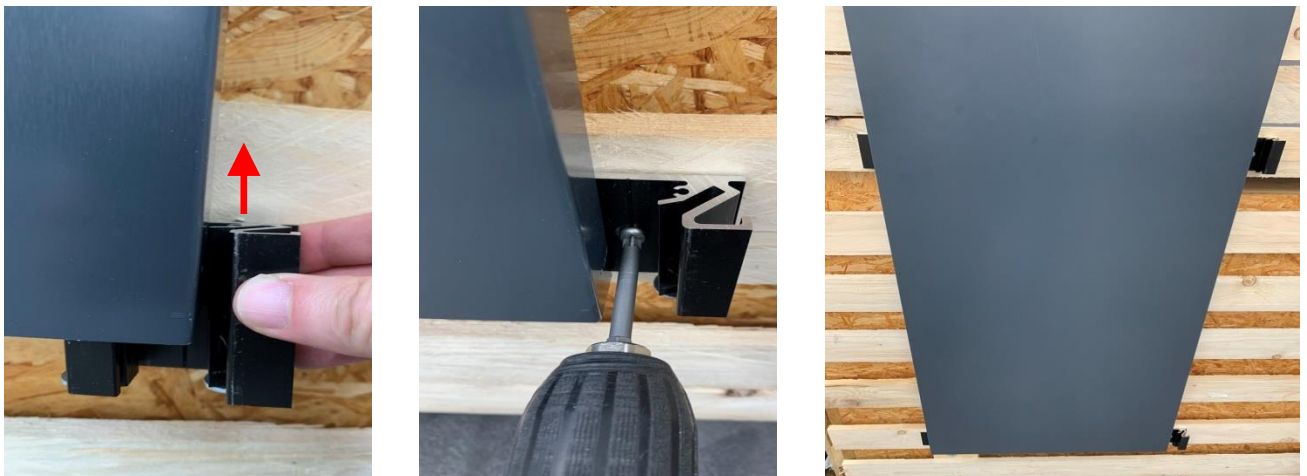

# easy fiX 135°/90°

## Installation – vertical layout

- Insert the panel into the profiles



- Insert the end profiles into the fold on the right



**2 screws for the end profile at bottom**

# easy fiX 135°/90°

## Installation – vertical layout

- Slide the end profile in front of the support, 2 screws are required for the bottom profile

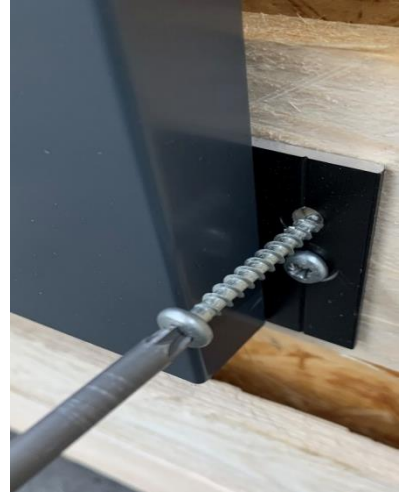
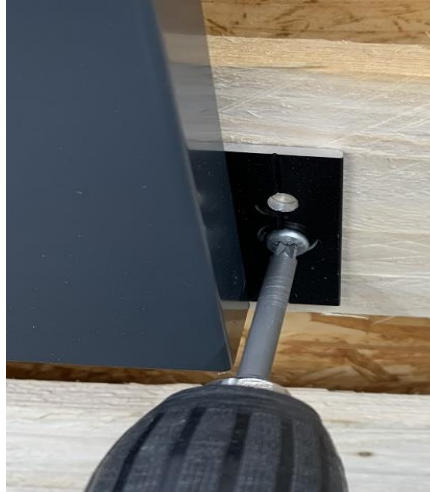
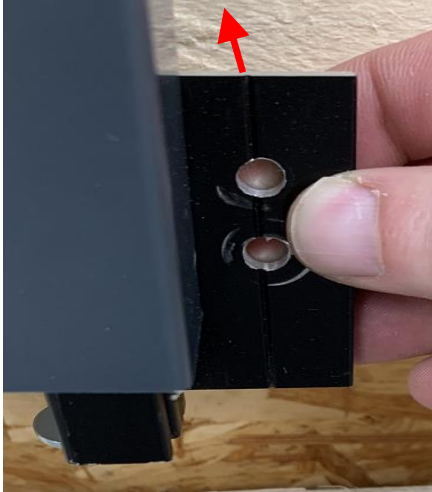

## Technical details – vertical layout

- Vertical joint

**ALUCOBOND®**

Fascia, easy fiX Panels - Vertical Layout  
- Short fixing profiles

Vertical joint (Section 2-2) M 1:2

Vertical section see page 3.10

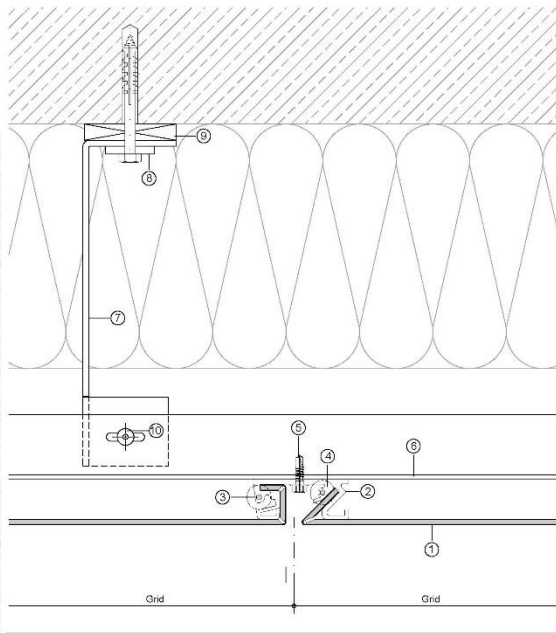
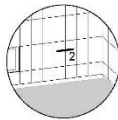

- ① ALUCOBOND
- ② easy fiX Standard Profile 55010 (Short piece L=80 mm)
- ③ Screw Mx18 (WÜRTH GEFU TT2000)
- ④ Stainless steel washer Ø=16 mm
- ⑤ Self-tapping screw or self-drilling screw

- ⑥ L-section
- ⑦ Wall bracket for horizontal substructure
- ⑧ Extruded Al-liner
- ⑨ Plastic board (thermal separation)
- ⑩ Aluminium Blind rivet

Part 2 3.20

**ALUCOBOND®**

Fascia, easy fiX Panels - Vertical Layout  
- Short fixing profiles

Vertical joint (Section 2-2) M 1:2

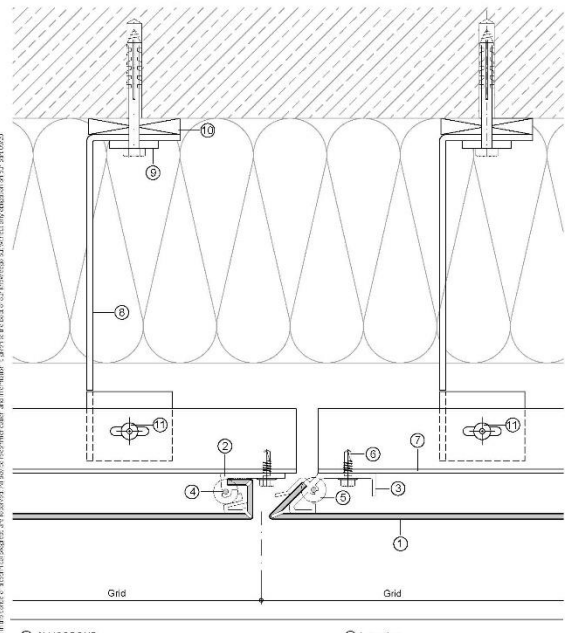
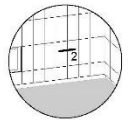

- ① ALUCOBOND
- ② easy fiX 90° Profile 55011 (Short piece L=80 mm)
- ③ easy fiX 135° Profile 55013 (Short piece L=80 mm)
- ④ Screw Mx18 (WÜRTH GEFU TT2000)
- ⑤ Stainless steel washer Ø=16 mm
- ⑥ Self-tapping screw or self-drilling screw

- ⑦ L-section
- ⑧ Wall bracket for horizontal substructure
- ⑨ Extruded Al-liner
- ⑩ Plastic board (thermal separation)
- ⑪ Aluminium Blind rivet

Part 2 3.20A

Next & Beyond.  
**ALUCOBOND®**



**COMPOSITES**

3A Composites GmbH  
Alusingenplatz 1  
78224 Singen, Germany  
Phone +49 7731 - 941 2060  
info@alucobond.com  
www.alucobond.com